

Seitenansicht

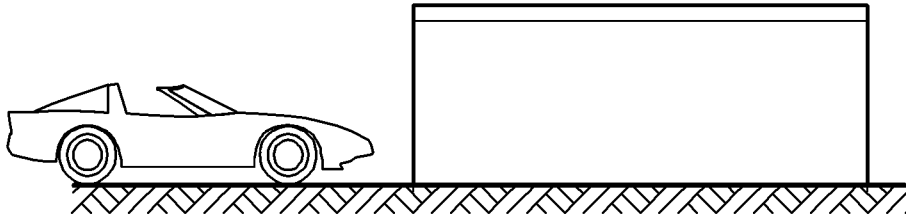

Längsschnitt

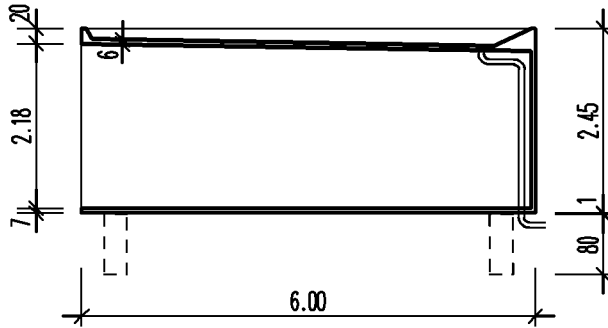

Vorderansicht

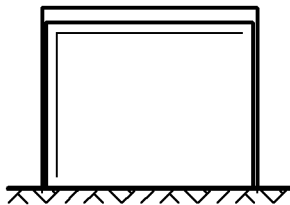

Querschnitt

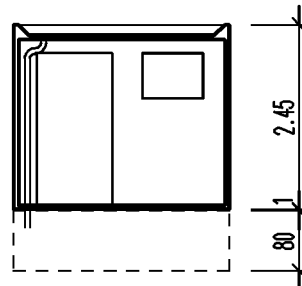

Grundriss

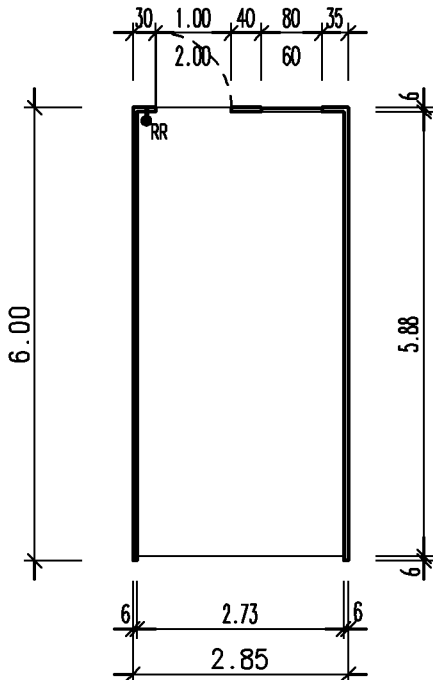

Gründung

gem. Typenstatik

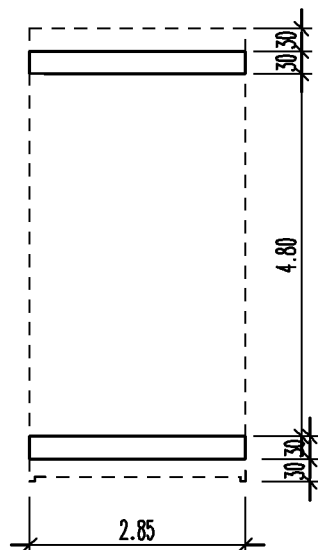

Bauherr

·
·
·

Bauvorhaben

·
·
·

Auftrag
Stand: 17/04/03 Dr.

Entwurfsverfasser

Nutzfl. : 16.05 qm
umb.Raum: 41.89 cbm

Garage Typ K

M. 1:100

k3sbtfrw