

# Seitenansicht

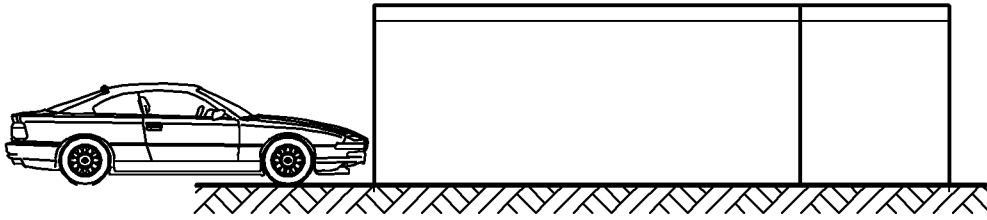

# Längsschnitt

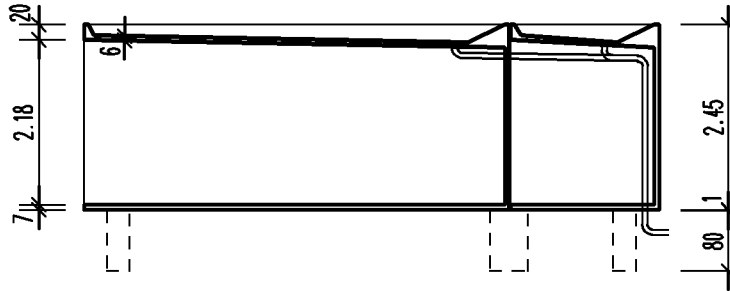

Bauherr

·  
·  
·

# Vorderansicht

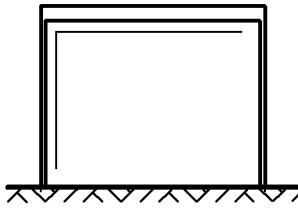

# Querschnitt

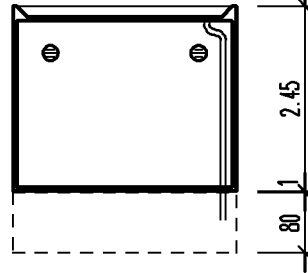

Bauvorhaben

·  
·  
·

Auftrag  
Stand: 20/06/03 PDr.

# Grundriss

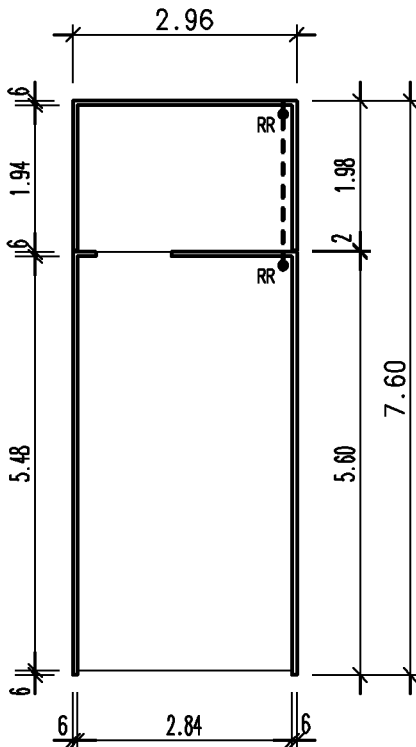

# Gründung

gem. Typenstatik

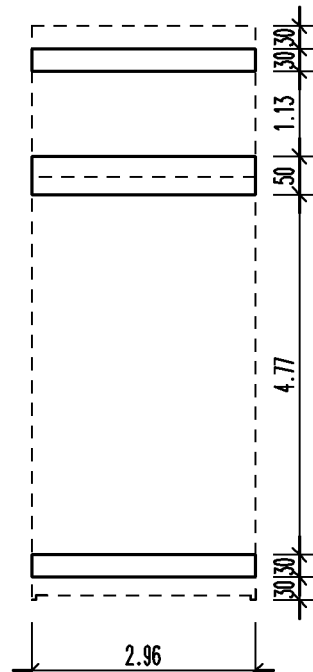

Entwurfsverfasser

Nutzfl. : 21.24 qm  
umb.Raum: 55.12 cbm

Garage Typ K

M. 1:100