

Seitenansicht

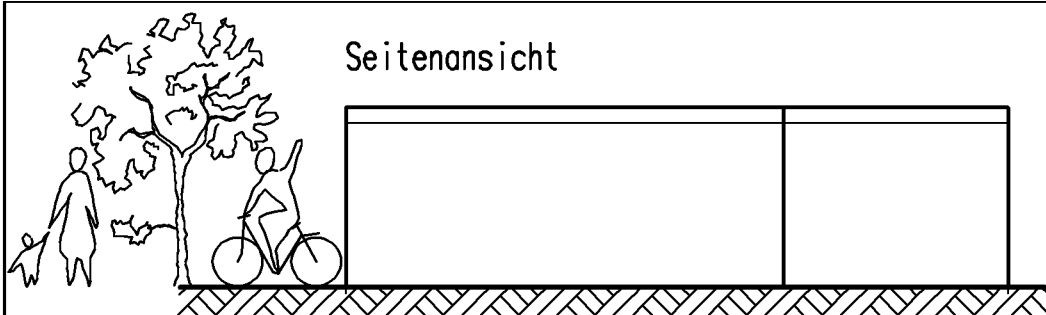

Längsschnitt

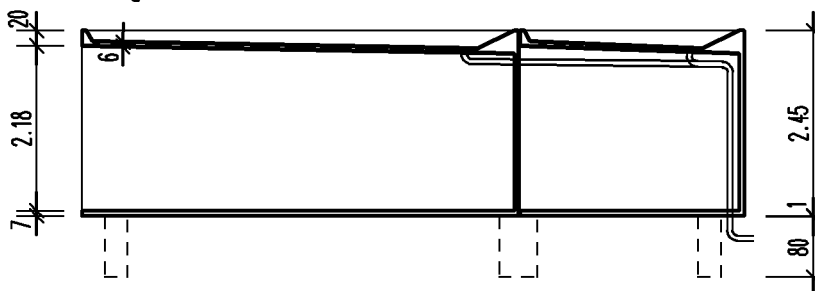

Vorderansicht

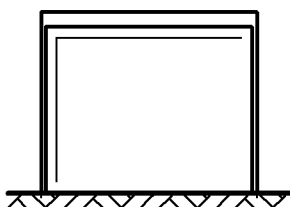

Querschnitt

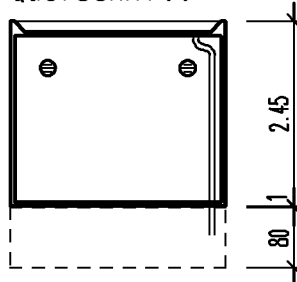

Grundriss

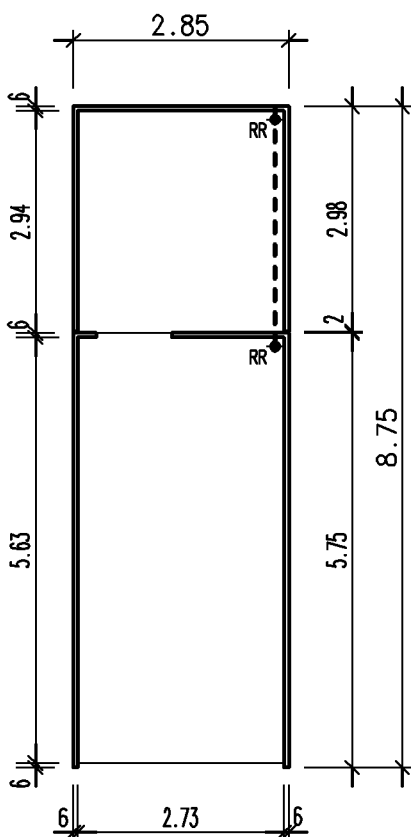

Gründung

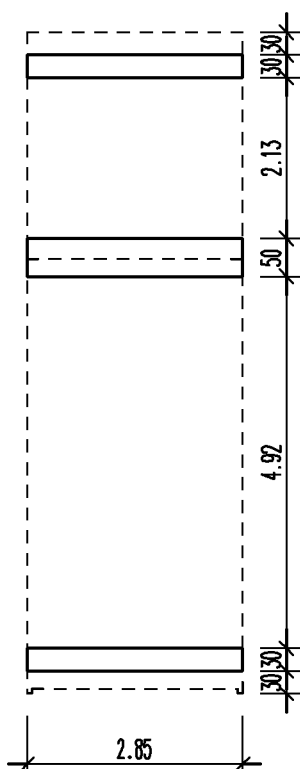

Bauherr

·
·
·

Bauvorhaben

·
·
·

Auftrag
Stand: 18/06/03 PDr.

Entwurfsverfasser

Nutzfl. : 23.56 qm
umb.Raum: 61.10 cbm

Garage Typ K

M. 1:100

s1-1a3