

Seitenansicht

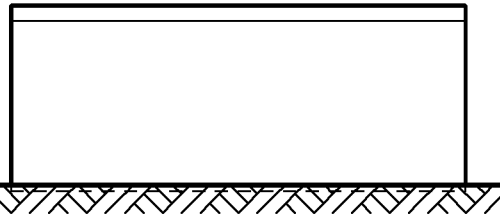
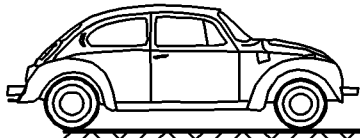

Bauherr

·
·
·

Längsschnitt

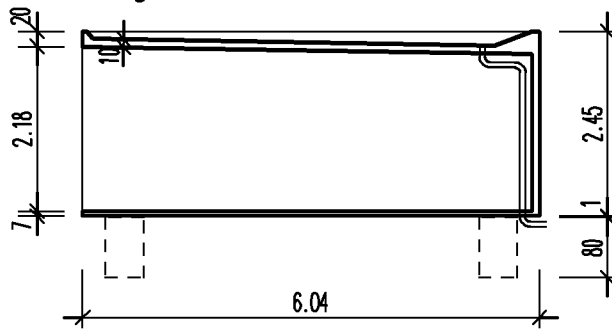

Bauvorhaben

·
·
·

Vorderansicht

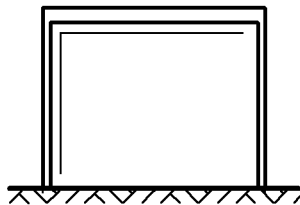

Querschnitt

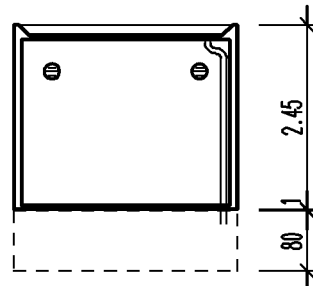

Auftrag
Stand: 19/11/02 Dr.

Grundriss

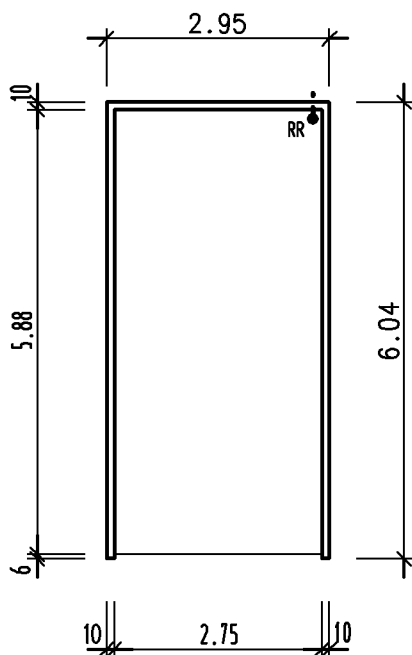

Gründung

gem. Typenstatik

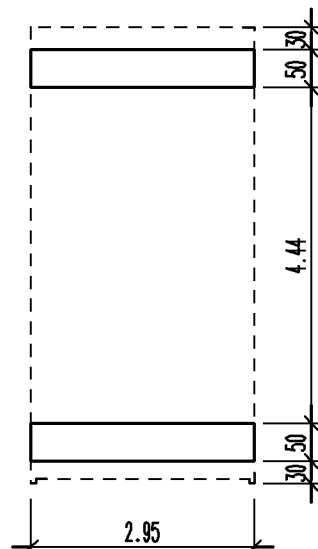

Entwurfsverfasser

Nutzfl. : 16.17 qm
umb.Raum: 43.65 cbm

Garage Typ K

M. 1:100