

# Seitenansicht

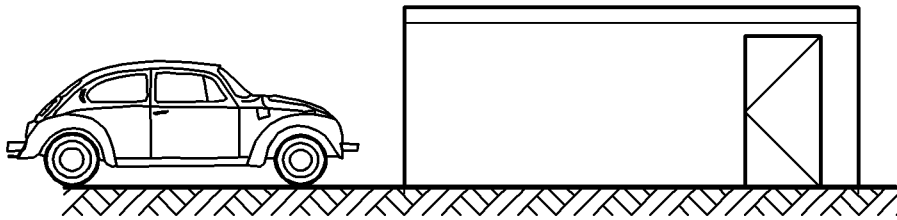

# Längsschnitt

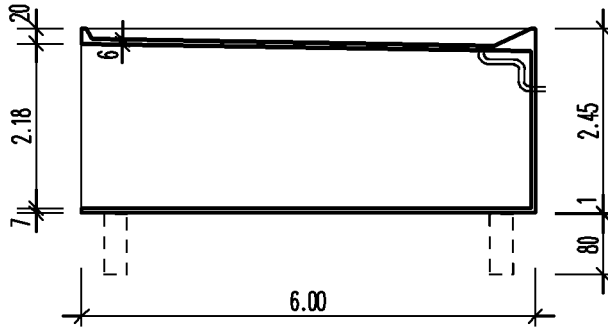

# Vorderansicht

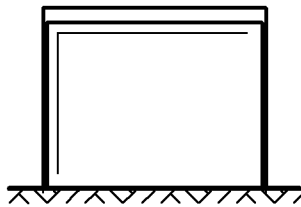

# Querschnitt

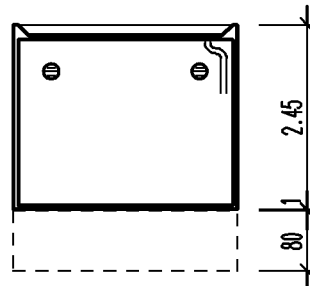

# Grundriss

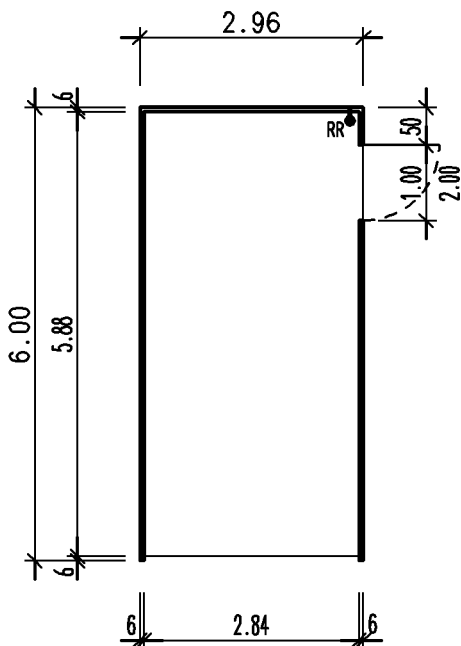

# Gründung

gem. Typenstatik

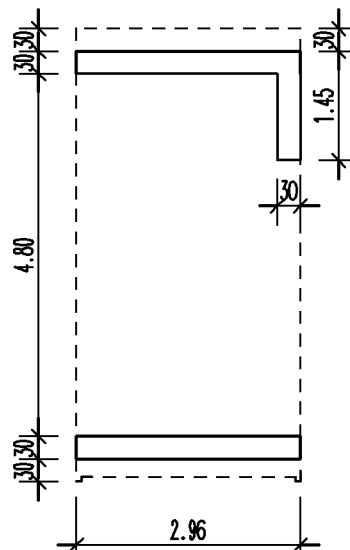

## Bauherr

...

## Bauvorhaben

...

Auftrag  
Stand: 19/11/02 Dr.

## Entwurfsverfasser

Nutzfl. : 16.70 qm  
umb.Raum: 43.51 cbm

Garage Typ K

M. 1:100

k3-1tswr