

# Seitenansicht

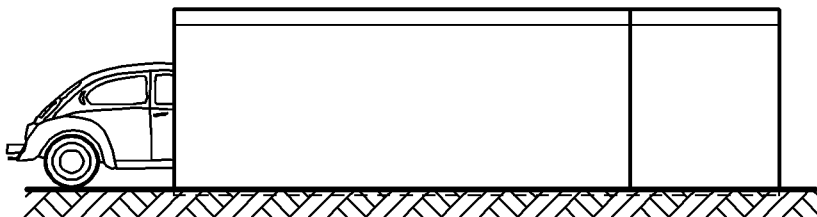

# Längsschnitt

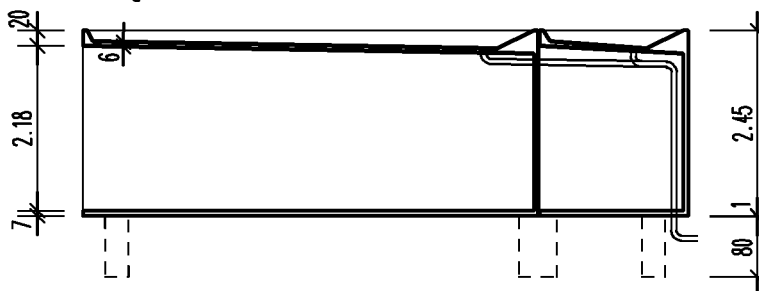

# Vorderansicht

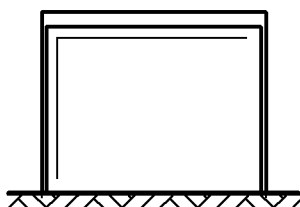

# Querschnitt

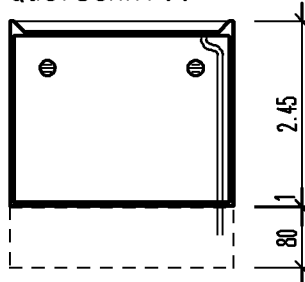

# Grundriss

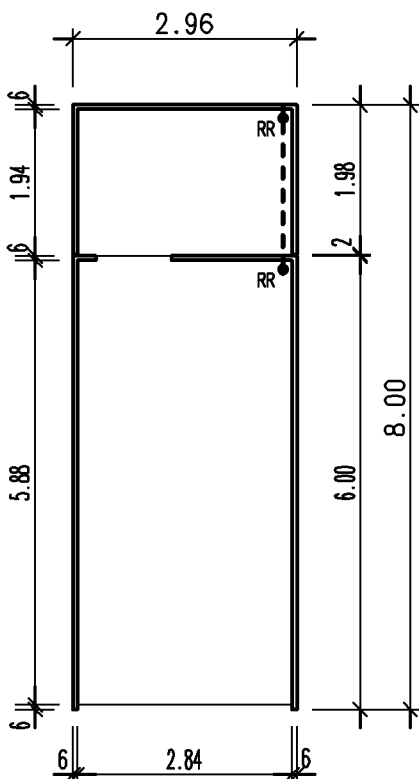

# Gründung gem. Typenstatik

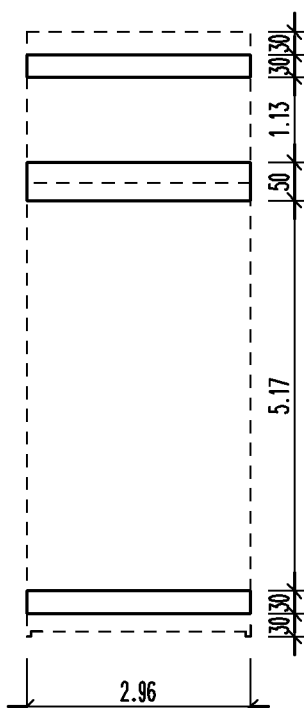

## Bauherr

·  
·  
·

## Bauvorhaben

·  
·  
·

Auftrag  
Stand: 17/04/03 Dr.

## Entwurfsverfasser

Nutzfl. : 22.38 qm  
umb.Raum: 58.02 cbm

Garage Typ K

M. 1:100